

# EVMU / EVMUG

Model EVMU

EBARA Stainless Steel Vertical Multistage

Sectional View

(For reference only. See pricing for part availability.)

Models EVMU2  
EVMU4  
EVMU8  
EVMU16

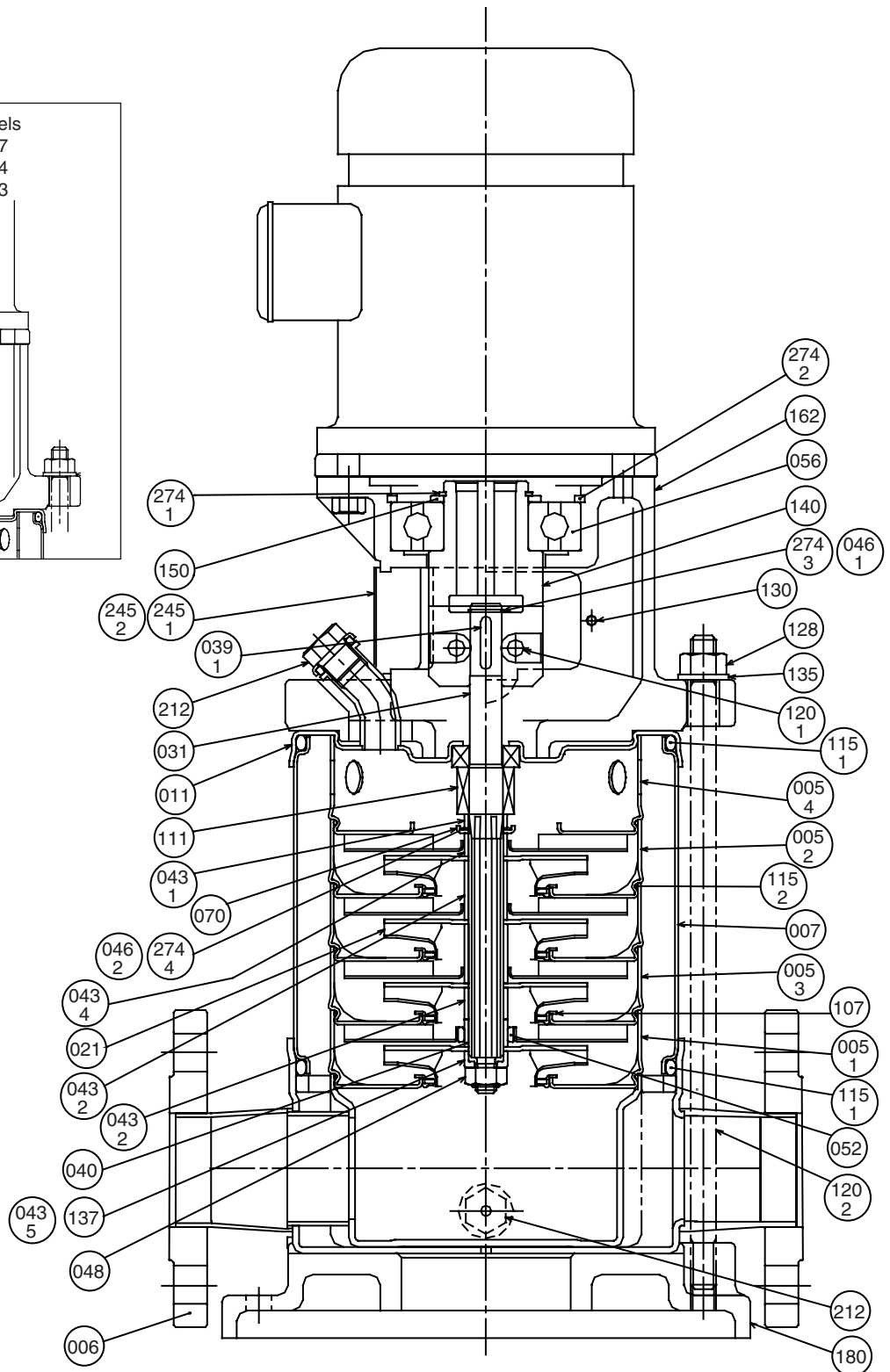
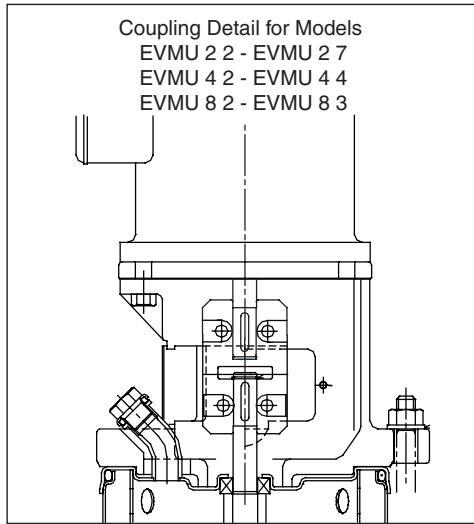

Refer to page 822 for dimension details.

**Model EVMU****EBARA Stainless Steel Vertical Multistage****Sectional View – part reference***(See pricing for part availability.)*

<b>Location No.</b>	<b>Part Name</b>	<b>Material</b>
005/1	Intermediate casing suction	AISI 304
005/2	Intermediate casing	AISI 304
005/3	Intermediate casing bearing	AISI 304
005/4	Intermediate casing discharge	AISI 304
006	Bottom casing	AISI 304
007	Outer casing	AISI 304
011	Casing cover	AISI 304
021	Impeller	AISI 304
031	Shaft	AISI 304
039/1	Key (pump shaft)	AISI 304
040	Bearing sleeve	Tungsten carbide
043/1	Shaft sleeve (mechanical seal)	AISI 304
043/2	Shaft sleeve (intermediate)	AISI 304
043/3	Shaft sleeve (bearing)	AISI 304
043/4	Shaft sleeve (last stage)	AISI 304
043/5	Shaft sleeve (adjustment)	AISI 304
046/1	Split ring (shaft end)	Carbon tool steels
046/2	Split ring (mechanical seal)	AISI 304
048	U-Nut	AISI 304
052	Bearing	Tungsten carbide
056	Ball bearing	–
070	Ring Holder	AISI 304
107	Liner ring	AISI 304/EPDM
111	Mechanical seal	Sic/Carbon/FPM
115/1	O-ring (outer casing)	Viton
115/2	O-ring (intermediate casing)	EPDM
120/1	Bolt	Carbon steel
120/2	Casing bolt	Steel chromate
128	Nut (casing bolt)	Steel chromate
130	Screw	AISI 304
135	Washer	Steel
137	Spacer	AISI 304
140	Coupling	Carbon steel
150	Spacer	Carbon steel
160	Base	Cast iron
162	Motor bracket	Cast iron
212	Plug	AISI 304/Teflon
245/1	Coupling guard	AISI 304
245/2	Coupling guard	AISI 304
274/1	C-type snap ring (coupling)	Carbon tool steels
274/2	C-type snap ring (bracket)	Carbon tool steels
274/3	C-type snap ring (shaft end)	Carbon tool steels
274/4	C-type snap ring (mechanical seal)	AISI 304

# EVMU / EVMUG

Model EVMUG

EBARA Stainless Steel Vertical Multistage

Sectional View

Model EVMUG32

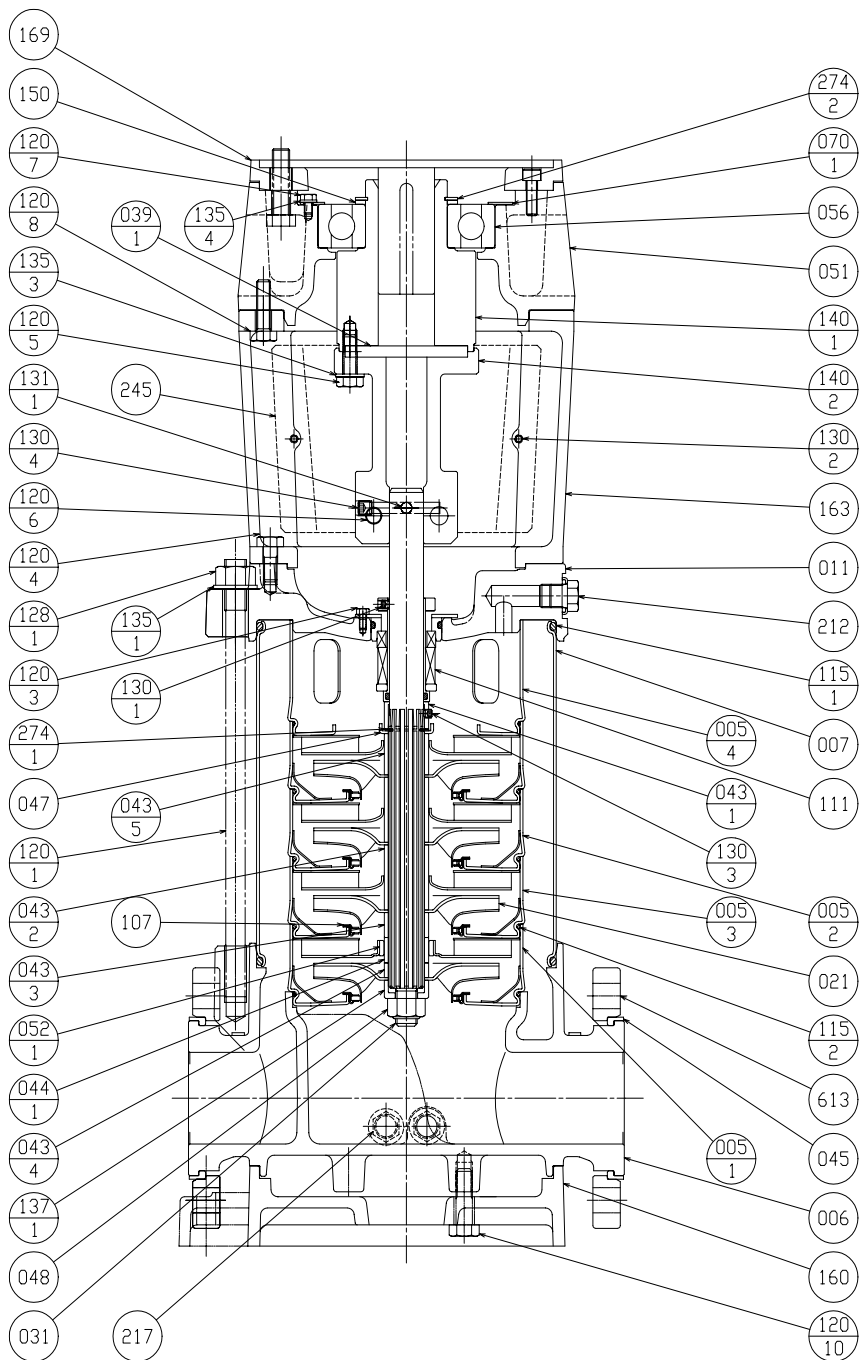
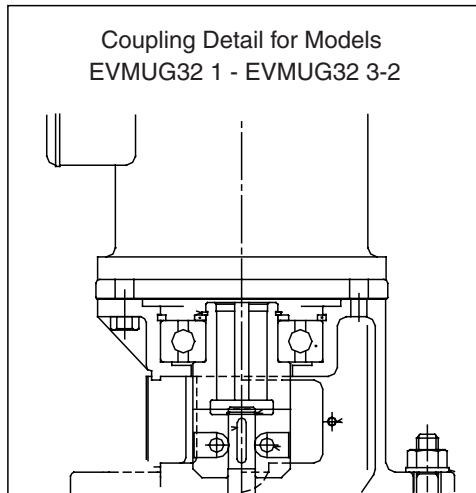

Refer to page 824 for dimension details.

**EVMU / EVMUG****Model EVMUG****EBARA Stainless Steel Vertical Multistage****Sectional View – part reference****(See pricing for part availability.)****Model EVMUG32**

Location No.	Part Name	Material
005-1	Stage casing (suction)	AISI304
005-2	Stage casing	AISI304
005-3	Stage casing (bearing)	AISI304
005-4	Stage casing (top)	AISI304
006	Bottom casing	Cast iron
007	Outer sleeve	AISI304
011	Casing cover	Cast iron
021	Impeller	AISI304
031	Shaft	AISI316
039-1	Key (coupling)	Steel
043-1	Shaft sleeve (mechanical sleeve)	AISI304
043-2	Shaft sleeve (stage)	AISI304
043-3	Shaft sleeve (bearing/upper)	AISI304
043-4	Shaft sleeve (bearing/lower)	AISI304
043-5	Shaft sleeve (top)	AISI304
044-1	Bearing sleeve (stage)	Tungsten carbide
045	Adjusting ring	Steel
047	Split ring retainer	AISI304
048	Friction nut	AISI304
051	Bearing housing	Cast iron
052-1	Bearing (stage)	Tungsten carbide
056	Ball bearing	-
070-1	Bearing holder	AISI304
107	Wear ring	AISI 316+PTFE
111	Mechanical seal (Cartridge assembly)	SiC/Carbon/FPM/316
115-1	O-ring (outer)	FPM
115-2	O-ring (stage)	FPM
120-1	Tie rod bolt	Zincate steel
120-3	Bolt (mechanical seal)	Stainless steel A2-70
120-4	Bolt (casing cover)	Stainless steel A2-70
120-5	Bolt (coupling M-side)	Zincate steel
120-6	Bolt (coupling P-side)	Zincate steel
120-7	Bolt (bearing)	Zincate steel
120-8	Bolt (bearing housing)	Zincate steel
120-10	Bolt (base plate)	Zincate steel
128-1	Nut (tie-rod bolt)	Zincate steel
130-1	Screw (mechanical seal)	Stainless steel A2-70
130-2	Screw (coupling guard)	Stainless steel A2-70
130-3	Screw (mechanical seal)	Stainless steel A2-70
130-4	Screw (coupling pin)	Stainless steel
131-1	Pin (shaft)	Steel
135-1	Washer (tie-rod bolt)	Zincate steel
135-3	Spring washer (coupling bolt M-side)	Zincate steel
135-4	Spring washer (bearing)	Zincate steel
137-1	Shaft end sleeve	AISI304
140-1	Coupling upper half	Steel
140-2	Coupling lower half	Steel
150	Spacer (coupling)	Steel
160	Base plate	Cast iron
163	Motor stool	Cast iron
169	Motor liner	Cast iron
212	Vent plug (with seal ring)	AISI304/FPM
217	Plug (with seal ring)	AISI304/FPM
245	Coupling guard	AISI304
274-1	C-ring (top)	AISI304
274-2	C-ring (coupling)	Carbon tool steel
613	Pump flange	Steel

# EVMU / EVMUG

Model EVMUG

EBARA Stainless Steel Vertical Multistage

Sectional View

Models EVMUG45  
EVMUG64

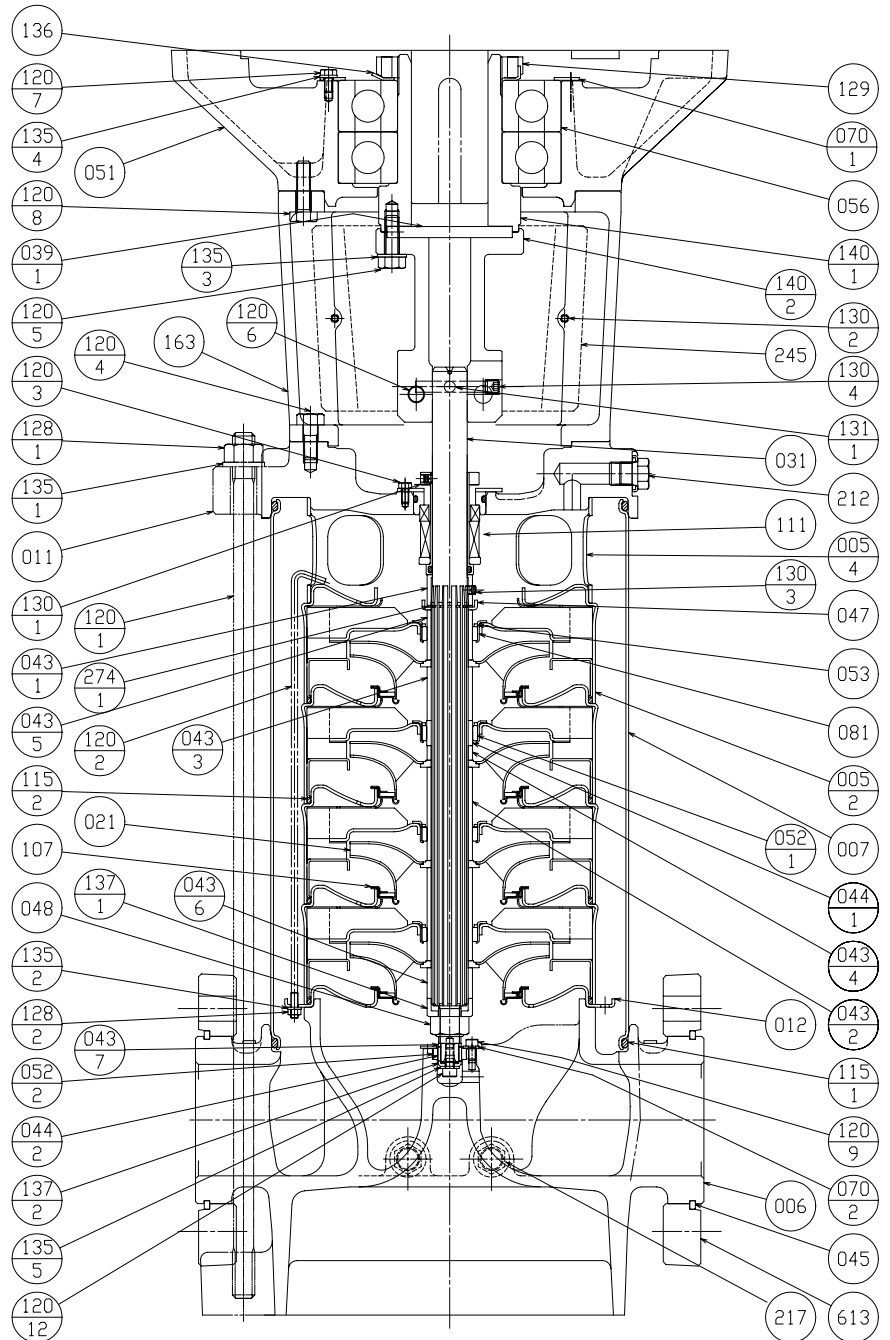
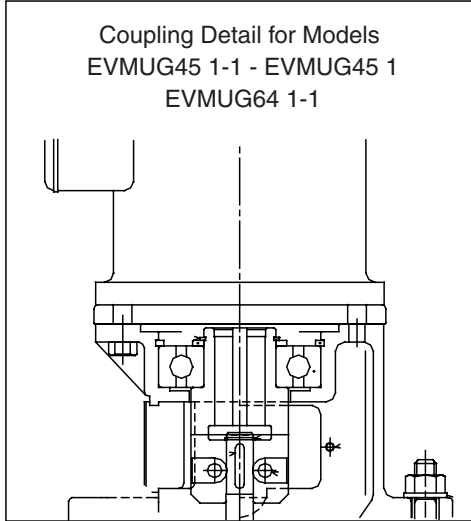

Refer to page 826 for dimension details.

**EVMU / EVMUG****Model EVMUG****EBARA Stainless Steel Vertical Multistage****Sectional View – part reference****(See pricing for part availability.)****Model EVMUG45 EVMUG64**

Location No.	Part Name	Material
005-2	Stage casing	AISI304
005-4	Top casing	AISI304
006	Bottom casing	Cast iron
007	Outer sleeve	AISI304
011	Casing cover	Cast iron
012	Suction cover	AISI304
021	Impeller	AISI304
031	Shaft	AISI316
039-1	Key (coupling)	Steel
043-1	Shaft sleeve (mechanical seal)	AISI304
043-2	Shaft sleeve (stage)	AISI304
043-3	Shaft sleeve (bearing/upper)	AISI304
043-4	Shaft sleeve (bearing/lower)	AISI304
043-5	Shaft sleeve (top)	AISI304
043-6	Shaft sleeve (suction)	AISI304
043-7	Shaft sleeve (bottom bearing)	AISI304
044-1	Bearing sleeve (stage)	Tungsten carbide
044-2	Bearing sleeve (bottom bearing)	Tungsten carbide
045	Adjusting ring	Steel
047	Split ring retainer	AISI304
048	Friction nut	AISI304
051	Bearing housing	Cast iron
052-1	Bearing (stage)	Tungsten carbide
052-2	Bearing (bottom)	Tungsten carbide
053	Bush holder	AISI304
056	Ball bearing	-
070-1	Bearing holder	AISI304
070-2	Bearing holder (bottom bearing)	AISI304
081	Bush	PTFE (alloy)
107	Wear ring	AISI316+PTFE
111	Mechanical seal Cartridge ass'y	SiC/Carbon/FPM/316
115-1	O-ring (outer)	FPM
115-2	O-ring (stage)	FPM
120-1	Tie-rod bolt	Zincate steel
120-2	Stack bolt	AISI304
120-3	Bolt (mechanical seal)	Stainless steel A2-70
120-4	Bolt (casing cover)	Stainless steel A2-70
120-5	Bolt (coupling M-side)	Zincate steel
120-6	Bolt (coupling P-side)	Zincate steel
120-7	Bolt (bearing)	Zincate steel
120-8	Bolt (bearing housing)	Zincate steel
120-9	Bolt (bottom bearing)	Stainless steel A2-70
120-12	Bolt (shaft end)	Stainless steel A2-70
128-1	Nut (tie-rod bolt)	Zincate steel
128-2	Nut (Stack bolt)	AISI304
129	Bearing nut (coupling)	Carbon steel
130-1	Screw (mechanical seal)	Stainless steel A2-70
130-2	Screw (coupling guard)	Stainless steel A2-70
130-3	Screw (mechanical seal)	Stainless steel A2-70
130-4	Screw (coupling pin)	Stainless steel
131-1	Pin (shaft)	Steel
135-1	Washer (tie-rod bolt)	Zincate s steel
135-2	Spring washer (Stack bolt)	AISI304
135-3	Spring washer (coupling bolt M-side)	Zincate steel
135-4	Spring washer (bearing)	Zincate steel
135-5	Spring washer (shaft end)	AISI304
136	Bearing washer (coupling)	Carbon steel
137-1	Shaft end sleeve	AISI304
137-2	Shaft end sleeve	AISI304
140-1	Coupling upper half	Steel
140-2	Coupling lower half	Steel
163	Motor stool	Cast iron
212	Vent plug (with seal ring)	AISI304/FPM
217	Plug (with seal ring)	AISI304/FPM
245	Coupling guard	AISI304
274-1	C-ring (top)	AISI304
613	Pump flange	Steel